



## Quick Start Guide

# Guardi 2



## Know Your Guardi 2

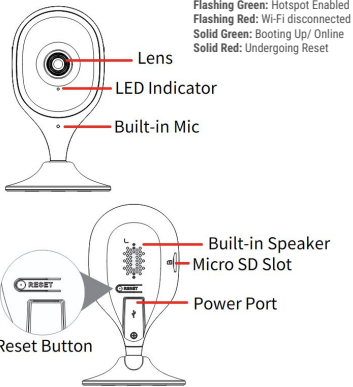

## Package Contents

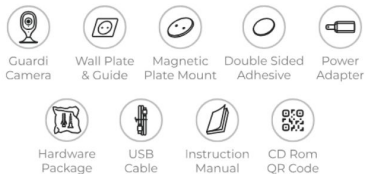

## Installation



The Guardi 2 includes a Metal mount for the magnetic Base to stick onto, as well as a Double-sided adhesive.

**Step 1** Mark the Mounting Holes. Use the included template to mark the screw holes and drill them. Install Wall Anchor if installing on stucco, brick, or concrete. For wood, drywall or soft surface, skip this step

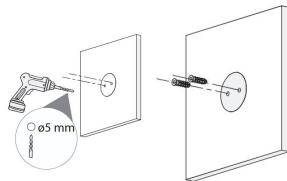

**Step 2** Install the Magnetic Base. Using the Phillips-head screwdriver and included screws install the base.

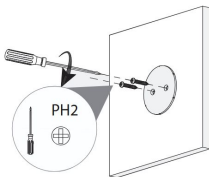

**Step 3** Install the Camera Body to the Base. The Base of the Guardi 2 is magnetic and will stick to the mount.

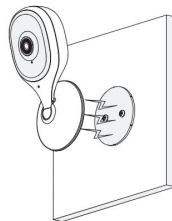

**Step 4** Connect the Power cable. Connect the included power supply to the camera's Power Port and plug the other end into a wall outlet.

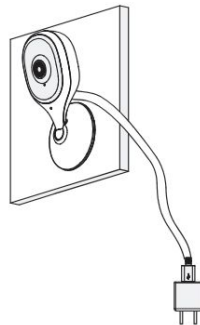

## Using IC View Pro

1 Power on the Guardi 2 camera and download the IC View Pro App from Google Play or the Apple App Store.



2 Open the App, and register a new account if you do not already have one.

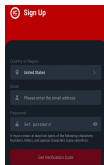

3 On the device page of the app press the "+" icon to initiate QR code scanning.

4 Scan the QR code on the back of the Guardi 2. You can also manually enter the serial number on the following page.

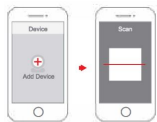

5 Tap "Next" if you should see a flashing green light on the front of the camera that indicates the hotspot is active (if not, press the reset button on the device).

6 Connect your mobile device to the Guardi 2's hotspot. The Wi-Fi name will appear as the *Guardi2-device serial number*.

7 Choose a password for your Guardi 2, then follow the in-app instructions.



8 Login to the local Wi-Fi network. Then, create a device name and set the time zone.

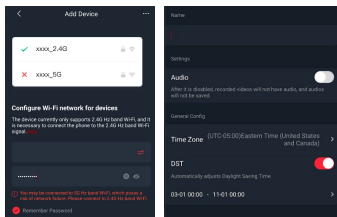

## Privacy Mode

The Guardi 2 includes a convenient Privacy Mode that instantly stops live audio and video and recording, giving you complete control and peace of mind whenever you need privacy.

To quickly enable Privacy Mode, tap on the  icon on the IC View Pro App.

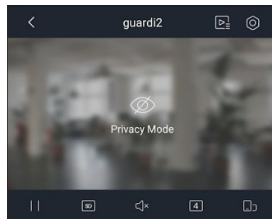

You can also go to **Device Details > Private Plan**. You can set up time periods when Privacy Mode will be enabled.

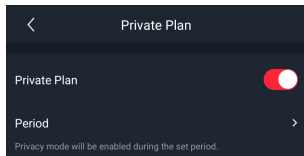

## Frequently Asked Questions

**Does the Guardi 2 support 5GHz Wi-Fi?**

No. It works only with 2.4GHz Wi-Fi networks.

**Why isn't the video camera turning on?**

- Make sure the camera is using the supplied power supply and that it is connected properly.

**How do I factory reset the Guardi 2?**

Locate the reset button behind the camera. While powered, press and hold the **RESET** button. Release it when you hear the audio prompt/chime. After a minute, a slow green light will show the camera is ready to set up.

**Why can't I connect the Guardi 2 to Wi-Fi?**

Wait for the camera to flash a slow green light. Then go to your phone's Settings > Wi-Fi and connect to the "Guardi2\_xxx" hotspot.

**Why is the camera offline?**

Check if the LED is solid green.

- If **yes**, check if your Wi-Fi router is online.
- If **no**, factory reset the camera and reconnect. Make sure the Wi-Fi signal is strong.

**Why can't I connect to the device hotspot?**

Make sure the IC View Pro app has Location and Wi-Fi permissions.

If your phone doesn't connect automatically, go to Wi-Fi settings and connect to the hotspot manually. Stay connected to the hotspot during setup.